

TAKSTAR® 得胜



PC-K200 | 专业录音麦克风
Professional Recording Microphone

使用手册 | User Manual

■ 前言

尊敬的用户：

感谢您选购得胜PC-K200专业录音麦克风，为了您能够更好的了解使用本产品，建议您在使用前仔细阅读本说明书。

若存在有疑问或者您有宝贵的建议，可通过拨打得胜官方服务热线400 6828 333或微信扫描二维码关注得胜官方公众号与我们联系。



■ 产品特性

- 外观优化升级，流线设计更美观，全金属，坚固耐用；
- 音色全面提升，三频均衡、音色通透、富有磁性；
- 采用超低底噪电路设计，声音更干净，清晰；
- 保留电源指示灯设计，方便了解麦克风是否处于工作状态；
- 配置简易麦克风夹子，小巧便携，使麦克风安装更简便；
- 配置防风棉，有效保护麦克风免受潮及降低喷麦声。

■ 适用范围

直播K歌、个人录音、乐器录音等场合

■ 产品配置

- 麦克风1支
- 防风棉1个
- 麦克风夹子1个
- 说明书1份

■ 技术参数

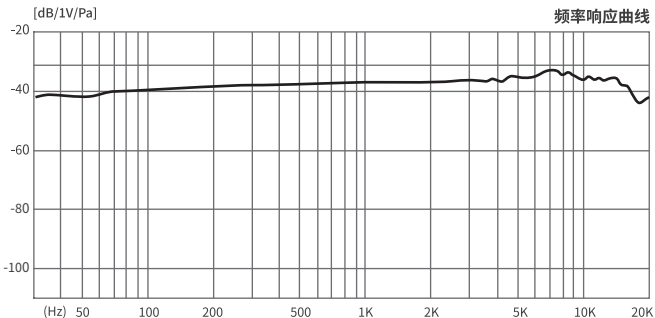

- 音头：Φ16mm电容音头
- 指向性：心型指向
- 频率响应：20Hz-20KHz
- 灵敏度：-36dB±3dBV(0dB=1V/Pa at 1KHz)
- 等效噪声级：≤28dBA (IEC 581-5)
- 峰值声压级：130dB(THD≤0.5% at 1KHz)
- 输出阻抗：200Ω±30%(at 1KHz)
- 工作电压：48V幻象电源
- 单体尺寸：Φ54mm×148mm
- 单体重量：约351g

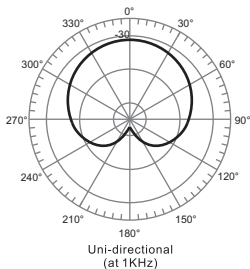

注：以上数据由得胜实验室测试得到，并拥有最终解释权！

■ 功能示意

- ① 电源指示灯：麦克风和相关设备连通时，指示灯常亮蓝灯，表示麦克风进入工作状态；断开卡侬线，指示灯熄灭。
- ② XLR接口：通过卡侬线与音频设备（声卡、调音台、功放等）连接。

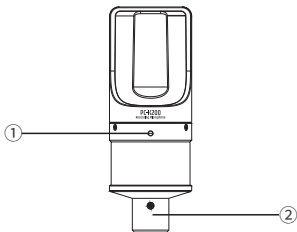

■ 使用说明

- 1 将麦克风夹子按顺时针方向旋转连接到麦克风支架或吊杆上；
2. 麦克风印有“PC-K200”型号及蓝色指示灯的一面为正面，确保将麦克风的这一面对准声源，安置到麦克风夹子中。调整麦克风至合适的角度，旋紧麦克风夹子的螺母直到完全夹紧麦克风。建议麦克风安装好后正面朝上，以防麦克风夹不紧时从麦克风夹子中脱落造成损坏；如图所示：
3. 将附带的防风棉安装至麦克风上；

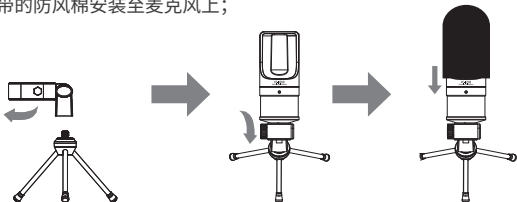

提示：防风棉可以起到防喷发声及防口水的作用，更好的保护麦克风音头不受潮，但对声音的通透性稍微有影响，可根据个人喜好选择是否安装防风棉。

PC-K200 专业录音麦克风

4. 将卡侬线插头插入麦克风底部的输出接口，旋转插头上的扣键使其麦克风的槽口对准，然后将插头推入麦克风，直至扣键定位。另一端连接到具有48V幻象电源供电的音频设备（如声卡、调音台、功放等），如果设备本身没有幻象电源，则需要另购一个48V幻象电源进行连接。

注意：本产品需求的48V幻象电源规格： $DC\ 48V \pm 4V / 2.8mA \pm 20\%$

① 音频设备带48V幻象电源供电的连接方法：

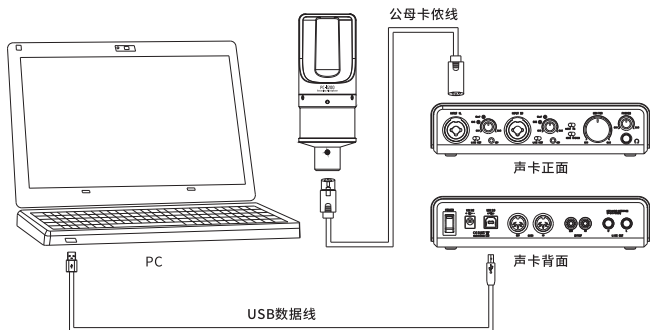

PC-K200 专业录音麦克风

② 音频设备不带48V幻象电源供电的连接方法：

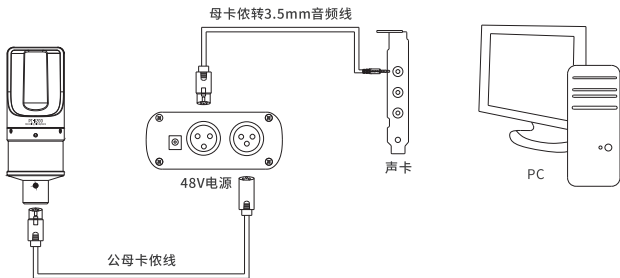

5. 将连接线固定在麦克风支架或吊杆上，在麦克风位置预留一圈连接线，这种做法可实现有效的隔震效果。

6. 建议使用时，应先将所连接的音频设备音量调小，再打开幻象电源开关，并将音量从小到大慢慢调节至合适，以免声压过大对扬声器产生冲击；尽可能的拉开麦克风与扬声器的距离，避免麦克风和扬声器相对，从而有效控制回馈啸叫。

7. 麦克风输出接口是三针XLR接口，其极性如图所示：

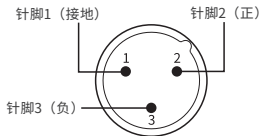

■ 安全警示

为避免电击、高温、着火、辐射、爆炸、机械危险以及使用不当等可能造成的人身伤害或财产损失，使用本产品前，请仔细阅读并遵守以下事项：

1. 使用产品时请确认所连设备与本产品是否匹配以及合理调整音量大小，不要在超过产品功率及大音量下长时间使用，以免造成产品异常；
2. 使用中若发现有异常（如冒烟、异味等），请立即关闭电源开关并拔掉电源插头，然后将产品送售后服务网点检修；
3. 本产品及配件都应放置在室内干燥通风处，请勿长期存放在潮湿、灰尘多的环境，使用中避免靠近火源、雨淋、进水、过度碰撞、抛掷、振动本机及覆盖通风孔，以免损坏其功能；
4. 若产品需要固定于墙壁或天花板时，请确保固定到位，防止因固定强度不足导致产品发生跌落危险；
5. 使用该产品时需遵守相关安全规定，法律法规明确禁止使用场合请勿使用本产品，以免导致意外事故；
6. 请不要自行拆机改装或维修，以防止出现人身伤害，如有问题或服务需求请联系当地售后服务网点跟进处理。

■ 关于图标含义解释



根据RL2004/108/EG和European Low Voltage Directive（欧洲低电压指令）RL2006/95/EG的测试结果表明，本产品符合欧共体关于电磁兼容性的成员国法律整合的指令中所规定的限值。



未经合规方明确批准的变更或修改可能会使用户失去操作设备的权限。此设备符合FCC规则第15条部分的要求。操作须符合以下两个条件：（1）此设备可能不会造成有害干扰；（2）此设备必须接受接收到的任何干扰，包括可能导致意外操作的干扰。



此符号表示，根据WEEE指令(2012/19/EU)和国家法律，由于这种类型的废弃物会有潜在的有害物质，可能对环境 and 人类健康产生负面影响，所以本产品不应与您的家庭垃圾一起处置，应将本产品交由授权的电气和电子设备（WEEE）回收站回收。同时，您在正确处理本产品的同时将有助于自然资源的有效利用。如需了解更多有关您可以在何处放置废物回收设备的信息，请联系您当地的城市办事处、废物管理局或家庭废物处理服务部门。

■ 关于本说明书

本说明书中内容符合截止印刷之日的技术规格。由于得胜公司会不断改进产品，本说明书可能不符合您的特定产品的技术规格。要获取最新版说明书，请访问得胜官网，然后下载说明书文件。技术规格、设备或另售的附件在各个地区可能有所不同，如有问题请与当地得胜销售网点确认。如需更多支持和深层产品信息，请浏览得胜官方网站：<https://www.takstar.com>

■ 环保说明

产品中有毒有害物质或元素的名称及含量标识表

部件名称	有毒有害物质或元素					
	铅 (Pb)	汞 (Hg)	镉 (Cd)	六价铬 (Cr(VI))	多溴联苯 (PBB)	多溴二苯醚 (PBDE)
塑料部件	○	○	○	○	○	○
金属部件	×	○	○	○	○	○
电路板组件	×	○	○	○	○	○
线缆	×	○	○	○	○	○

本表格依据SJ/T 11364的规定编制。

○: 表示该有害物质在该部件所有均质材料中的含量均在 GB/T 26572规定的限量要求以下。

×: 表示该有害物质至少在该部件的某一均质材料中的含量超出 GB/T 26572规定的限量要求。

此标志为产品的环保使用期限标志，
且此环保使用期限只适用于产品正常工作的温度和湿度等条件。



PC-K200 Professional Recording Microphone

■ Preface

Dear Customer,

Thank you for purchasing Takstar PC-K200 Professional Recording Microphone. In order to better understand and use the product, please read this manual carefully. If you have any questions or suggestions, please contact our local dealer.

■ Features

- Revamped, streamlined design, all-metal construction, simple yet elegant.
- Upgraded tonal performance, better balanced bass/mid/treble, transparent and enticing timber.
- Ultra-low self-noise circuit for cleaner and clearer audio.
- Retains power indicator for status overview at a glance.
- Includes a compact mic clamp that's easy to install and carry.
- Includes a windscreen that protects mic from moisture and minimizes pops noise.

■ Applications

Live broadcast, karaoke, personal recording, instrument recording

■ Package Contents

- Microphone1 PC
- Windscreen1 PC
- Mic Clamp.....1 PC
- User Manual.....1 PC

PC-K200 Professional Recording Microphone

■ Specifications

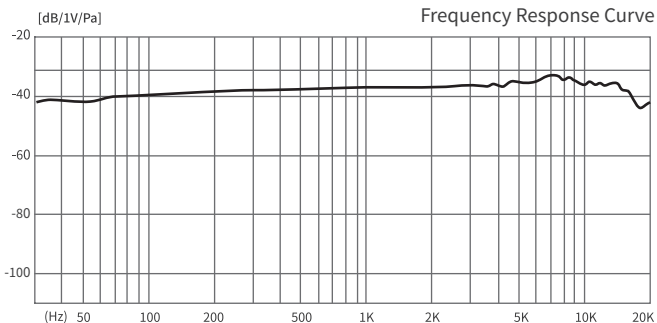

- Capsule: $\varnothing 16\text{mm}$ condenser
- Polar Pattern: cardioid
- Frequency Response: 20Hz-20KHz
- Sensitivity: $-36\text{dB} \pm 3\text{dBV}$ ($0\text{dB}=1\text{V/Pa}$ at 1KHz)
- Equivalent Noise Level: $\leq 28\text{dBA}$ (IEC 581-5)
- Peak SPL: 130dB (THD $\leq 0.5\%$ at 1KHz)
- Output Impedance: $200\Omega \pm 30\%$ (at 1KHz)
- Power Supply: 48V phantom power
- Dimensions: $\varnothing 54\text{mm} \times 148\text{mm}$
- Weight: about 351g

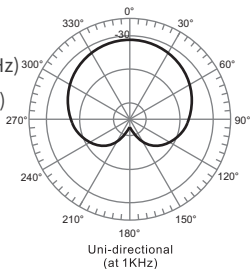

Note: The above data are measured by Takstar laboratory, and Takstar has the final interpretation right!

PC-K200 Professional Recording Microphone

■ Function Descriptions

- ① Power indicator: when the mic is connected to relevant device and running, the LED illuminates blue; when XLR cable is disconnected, the LED light will be off.
- ② XLR interface: connect with audio device (e.g., audio interface, mixer, power amp) via XLR cable.

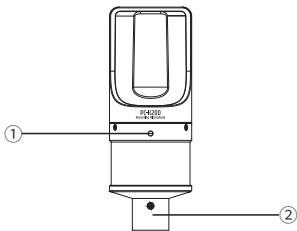

■ Operation Instructions

1. Install the mic clamp clockwise onto the mic stand or boom arm.
 2. The front side of the mic is the side with silkscreened “PC-K200” and blue LED indicator. Face the front side towards the sound source. Install the mic onto the mic clamp, adjust to a proper angle, and tighten the clamp screw until fully secured. It is recommended to keep the installed mic tilted upwards to prevent accidental mic drop and damage in case of loose mic clamping, as shown:
 3. Install the included foam windscreen onto the mic.
- Note: The foam windscreen can filter out plosives and protect microphone capsule from moisture such as speech droplets, but it may affect audio transparency slightly and therefore should be used at your preference.

PC-K200 Professional Recording Microphone

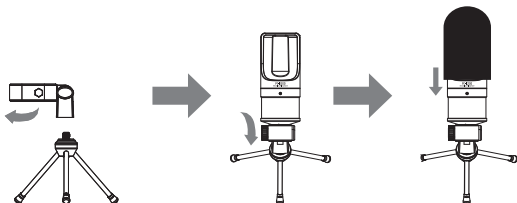

4. Align the lock button on XLR plug with the bottom socket on mic, then push the plug into the mic fully until it locks into place. Connect the other end of the XLR cable to an audio device (e.g., audio interface, mixer, power amp) with built-in 48V phantom power supply, or use an external 48V power supply (not included) if none;

Note: The phantom power supply requirement for this product is DC 48V ± 4V/2.8mA ± 20%.

① Connection for audio device with built-in 48V phantom power:

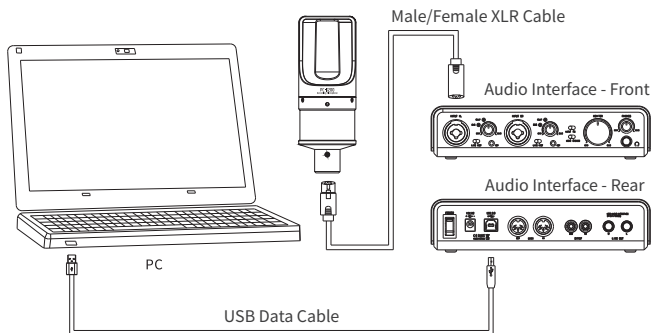

PC-K200 Professional Recording Microphone

② Connection for audio device without built-in 48V phantom power:

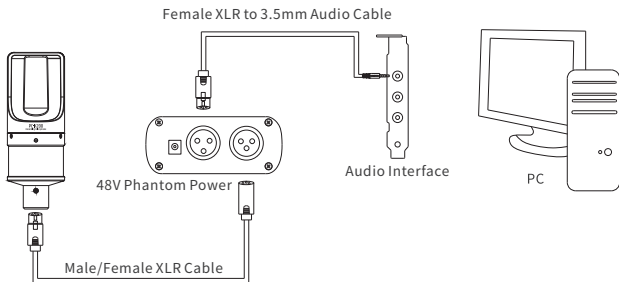

5. Fix the connection cable onto the mic stand or boom arm, and leave a section/loop of cable at the mic. This helps to effectively isolate the vibration.

6. Please turn the volume to the minimum on the audio device before switching on the phantom power. Then gradually increase the volume to an appropriate level. This helps to prevent speaker damage by high sound pressure. Keep a proper distance between mic and speakers, and try not to point the mic towards the speakers to avoid feedback howling.

7. The mic output uses a three-pin XLR male connector, as shown below:

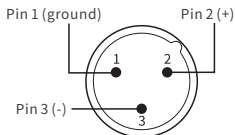

■ Safety Instructions

To avoid electric shock, overheat, fire, radiation, explosion, mechanical risk and injury or property loss due to improper use, please read and observe the following items before use:

1. Please check if the power of the connected equipment matches with that of this product before operation. Adjust the volume to proper level during operation. Do not operate at over-power or high-volume level for extended time to avoid product malfunction.
 2. If there is any abnormality during use (e.g., smoke, strange odor), please kill the power switch and unplug from power source, then send the product to the local dealer for repair.
 3. Keep this product and its accessories in a dry and ventilated area. Do not store in a humid or dusty area for extended time. Keep away from fire, rain, liquid intrusion, bumping, throwing, vibrating, or from blocking any ventilation openings, to prevent malfunction.
 4. The product must, when installed on walls or ceilings, be fixed firmly in place at adequate strength to prevent from falling.
 5. Please abide by safety rules during operation. Do not use the product in places prohibited by laws or regulations to avoid accident.
 6. Do not disassemble or repair the product by yourself to avoid injury.
- If you have any questions or require any services, please contact our local dealer.

PC-K200 Professional Recording Microphone

■ Label Meanings

CE This device is compliant with the limits of the European Council Directive on the approximation of the laws of the member states relating to electromagnetic compatibility according to RL2004/108/EG and European Low Voltage Directive RL2006/95/EG.

FCC Note: This equipment has been tested and found to comply with the limits for a Class B digital device, pursuant to part 15 of the FCC Rules. These limits are designed to provide reasonable protection against harmful interference in a residential installation. This equipment generates, uses, and can radiate radio frequency energy and, if not installed and used in accordance with the instructions, may cause harmful interference to radio communications. However, there is no guarantee that interference will not occur in a particular installation.

If this equipment does cause harmful interference to radio or television reception, which can be determined by turning the equipment off and on, the user is encouraged to try to correct the interference by one or more of the following measures:

- Reorient or relocate the receiving antenna.
- Increase the separation between the equipment and receiver.
- Connect the equipment to an outlet on a circuit different from that to which the receiver is connected.
- Consult the dealer or an experienced radio/TV technician for help.

Changes or modifications not expressly approved by the complying party may cause the user to lose permission to operate the device.

This device complies with part 15 of the FCC Rules. Operation is subject to the following two conditions:

PC-K200 Professional Recording Microphone

- 1) This device may not cause harmful interference, and
- 2) This device must accept any interference received, including interference that may cause undesired operation.



This symbol indicates that this product should not be disposed of with your household waste, according to the WEEE directive (2012/19/EU) and your national law. This product should be handed over to an authorized collection site for recycling waste electrical and electronic equipment (WEEE). Improper handling of this type of waste could have a possible negative impact on the environment and human health due to potentially hazardous substances that are generally associated with WEEE. At the same time, your cooperation in the correct disposal of this product will contribute to the effective usage of natural resources. For more information about where you can drop off your waste equipment for recycling, please contact your local city office, waste authority, or your household waste disposal service.

■ About This Manual

This manual contains up-to-date technical specifications as of printing. However, specifications contained herein may not conform to your particular product since Takstar is constantly improving its products. Also, specifications, devices or accessories available may vary from region to region. If you have any questions, please contact our local sales outlet. For the latest version/more information, please visit our website:
<https://www.takstar.com/>



产品服务保证书

姓名：_____ 电话：_____ 地址：_____

商品：_____ 型号：_____ 购买日期：_____ 年 ___ 月 ___ 日

注意事项：

1. 本单为保修凭证，请用户妥善保管，如有遗失，恕不保修或退换。
2. 保修期限制：购买之日起十二个月内。
3. 除了不可抗力事件损坏外，由本公司负责，免费维修。
4. 如属保管不善或使用不当造成的损坏，维修点将酌情收费。
5. 擅自拆卸维修者，不予保修。
6. 以上保修条款仅限于中国市场适用（不包含港澳台地区）。

维修记录栏(由维修员填写)	维修员签名	日期



扫一扫，了解更多产品
Scan for more
product information

广东省电声工程技术研究开发中心 广东得胜电子有限公司制造

地址：广东省惠州市博罗县龙溪街道富康一路2号

服务热线：400 6828 333 传真：0752 6383950

邮箱：xs@takstar.com

网址：www.takstar.com

Guangdong Takstar Electronic Co., Ltd.

Address: No. 2 Fu Kang Yi Rd., Longxi Boluo

Huizhou, Guangdong 516121 China

Tel: 86 752 6383644 Fax: 86 752 6383952

Email: sales@takstar.com

Website: www.takstar.com