

# TAKSTAR® 得胜



## PM5 (GEN 2)

### 48V幻象电源

48V Phantom Power Supply

使用手册 | User Manual

# PM5 (GEN 2) 48V幻象电源

---

## ■ 前言

尊敬的用户：

感谢您选购得胜PM5 (二代) 48V幻象电源，为了您能够更好地了解使用本产品，建议您在使用前仔细阅读本说明书。

若存在有疑问或者您有宝贵的建议，可通过拨打得胜官方服务热线400 6828 333或微信扫描



## ■ 产品特性

- 48V幻象电源，适用于各种需要48V幻象供电的电容麦克风；
- 内置低通滤波电路，充分滤除信号干扰，确保信号纯净；
- DC 48V升压整流电路，保障电压的稳定输出，抑制共模干扰；
- 一对XLR平衡输入、输出的卡侬接口，供电稳定，抗干扰；
- 精致小巧铝合金机身，阳极氧化处理，防刮耐磨，方便携带；
- 内置1500mAh锂电池，续航时间约10小时，支持边充边用。

## ■ 适用范围

直播K歌、个人录音、户外演出等场景

## ■ 标准配置

PM5幻象电源.....	1台
充电线.....	1条
说明书.....	1份

## PM5 (GEN 2) 48V幻象电源

### ■ 技术参数

- 输出电压: DC 48V $\pm$ 4V/20mA $\pm$ 20%
  - 信噪比: 84dB (1kHz@30mVrms)
  - 总谐波失真: THD<0.5% 1kHz
  - 电池类型: 锂离子电池
  - 电池容量: 1500mAh
  - 充电方式: 5V=1A
  - 充电时间: 约2小时
  - 使用时间: 约10小时 (48V开启)
  - 产品净重: 约162g
  - 尺寸: 100mm $\times$ 38mm $\times$ 44mm (长 $\times$ 宽 $\times$ 高)
- 注: 以上数据由得胜实验室测试得到, 并拥有最终解释权!

### ■ 功能示意

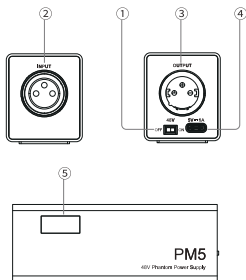

## PM5 (GEN 2) 48V幻象电源

---

- ① 48V电源开关：拨到“ON”位置为开启48V供电，拨到“OFF”位置为关闭48V供电；
- ② INPUT输入接口：标准XLR卡侬输入接口，连接需要48V幻象供电的电容麦克风；
- ③ OUTPUT输出接口：标准XLR卡侬输出接口，连接声卡、调音台、户外音箱等音频设备；
- ④ Type-C充电接口：通过附赠的充电线给PM5幻象电源充电，支持边充边用；
- ⑤ 电量指示灯：电量符号有4格，每格代表25%电量。

### ■ 使用说明

#### 一、使用说明

若您的声卡、调音台或音箱等音频设备没有48V幻象供电功能，无法连接需要48V幻象供电的电容麦克风时，通过连接“PM5幻象电源”，可以解决这一困扰。

#### 二、连接方法

下面以得胜的“OPS-25 PRO 音箱”以及“PCM-5600手持电容麦克风”为例，讲述“PM5幻象电源”的连接使用方法：

- 1、首先将“PM5幻象电源”与得胜“PCM-5600麦克风”连接。通过得胜的“C3-2公母卡侬线”（线材需自行另购）的卡侬母头一端连接“PCM-5600麦克风”，公头一端连接“PM5幻象电源”的INPUT输入接口；
- 2、将“PM5幻象电源”与“OPS-25 PRO 音箱”连接。通过得胜的“C6-1卡侬转 $\Phi$ 6.3麦克风线”（线材需自行另购）的卡侬头一端连接“PM5幻象电源”的OUTPUT输出接口， $\Phi$ 6.3mm插头一端连接“OPS-25 PRO 音箱”的麦克风接口；

## PM5 (GEN 2) 48V幻象电源

3、为了减少电流冲击对设备造成损害，请先开启幻象电源，再打开声卡开关；关机时，请先关闭声卡开关，再关闭幻象电源。开关机间隔建议超过5秒，确保设备逐步进入稳定状态。

4、“PM5幻象电源”满电情况下可以使用时间约9小时。如果使用过程中出现电量不足的情况时，“PM5幻象电源”还具有边充边用功能，解决续航焦虑。您可以通过附赠的充电线连接充电宝或适配器，实现边充边用。

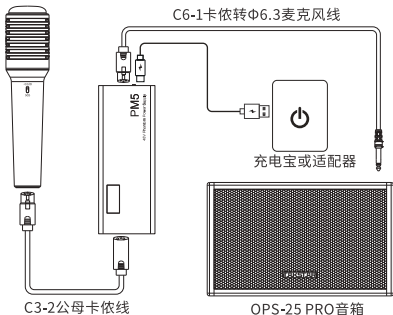

提示：声卡、调音台的连接方法类似，此处不再赘述

### 三、充电说明

1. 开启48V供电开关，电源指示灯最后一格红灯闪烁时，说明电源电量不足，需及时充电；
2. 使用附赠的Type-C充电线连接适配器进行充电。充电时，电量指示灯逐格点亮绿灯，表示正在充电中；充满电后，电量

## PM5 (GEN 2) 48V幻象电源

指示灯满格显示；使用5V=1A直流电源充电，约2小时即可充满；当电池电量充满时，请停止对电池充电，避免电池过充；  
3.初次使用时，建议先充满电；如长时间不使用，要每半年给“PM5幻象电源”充一次电，避免电池过放，对电池性能产生影响。

### ■ 安全警示

为避免电击、高温、着火、辐射、爆炸、机械危险以及使用不当等可能造成的人身伤害或财产损失，使用本产品前，请仔细阅读并遵守以下事项：

1. 使用产品时请确认所连设备与本产品是否匹配以及合理调整音量大小，不要在超过产品功率及大音量下长时间使用，以免造成产品异常；
2. 使用中若发现有异常（如冒烟、异味等），请立即关闭电源开关并拔掉电源插头，然后将产品送售后网点检修；
3. 消费者若使用电源适配器供电，则应购买配套使用获得CCC认证并满足标准要求的电源适配器；
4. 本产品及配件都应放置在室内干燥通风处，请勿长期存放在潮湿、灰尘多的环境，使用中避免靠近火源、雨淋、进水、过度碰撞、抛掷、振动本机及覆盖通风孔，以免损坏其功能；
5. 若产品需要固定于墙壁或天花板时，请确保固定到位，防止因固定强度不足导致产品发生跌落危险；
6. 使用该产品时需遵守相关安全规定，法律法规明确禁止使用场合请勿使用本产品，以免导致意外事故；
7. 请不要自行拆机改装或维修，以防止出现人身伤害，如有问题或服务需求请联系当地售后网点跟进处理。

## ■ 环保说明

产品中有害物质或元素的名称及含量标识表

部件名称	有害物质或元素									
	铅 (Pb)	汞 (Hg)	镉 (Cd)	六价铬 (Cr(VI))	多溴联苯 (PBB)	多溴二苯醚 (PBDE)	邻苯二甲酸 二正丁酯 (DBP)	邻苯二甲酸 二异丁酯 (DIBP)	邻苯二甲酸 丁基苯酯 (BBP)	邻苯二甲酸 二(2-乙基)己酯 (DEHP)
塑料部件	○	○	○	○	○	○	○	○	○	○
金属部件	×	○	○	○	○	○	○	○	○	○
电路板组件	×	○	○	○	○	○	○	○	○	○
线缆	×	○	○	○	○	○	○	○	○	○

本表格依据SJ/T 11364的规定编制。

○: 表示该有害物质在该部件所有均质材料中的含量均在GB/T 26572规定的限量要求以下。

×: 表示该有害物质至少在该部件的某一均质材料中的含量超出GB/T 26572规定的限量要求。

此标志为产品的环保使用期限标志，且此环保使用期限只适用于产品正常工作的温度和湿度等条件。



### ■ 关于图标含义解释



此符号表示，根据WEEE指令(2012/19/EU)和国家法律，由于这种类型的废弃物会有潜在的有害物质，可能对环境和人类健康产生负面影响，所以本产品不应与您的家庭垃圾一起处置，应将本产品交由授权的电气和电子设备（WEEE）回收站回收。同时，您在正确处理本产品的同时将有助于自然资源的有效利用。如需了解更多有关您可以在何处放置废物回收设备的信息，请联系您当地的城市办事处、废物管理局或家庭废物处理服务部门。

### ■ 关于本说明书

本说明书中内容符合截止印刷之日的技术规格。由于得胜公司会不断改进产品，本说明书可能不符合您的特定产品的技术规格。要获取最新版说明书，请访问得胜官网，然后下载说明书文件。技术规格、设备或另售的附件在各个地区可能有所不同，如有问题请与当地得胜销售网点确认。如需更多支持和深层产品信息，请浏览得胜官方网站：

<https://www.takstar.com>

版权所有 ©2025 得胜。得胜、TAKSTAR及其各自标志是得胜公司在中国和/或其他国家/地区的注册商标或商标。所有其它商标均是其各自所有者的财产。

## 注意事项:

1. 本单为保修凭证, 请用户妥善保管, 如有遗失, 恕不保修或退换货。
2. 保修期限制: 购买之日起十二个月内。
3. 除了不可抗力事件损坏外, 由本公司负责, 免费维修。
4. 如属保管不善或使用不当造成的损坏, 维修点将酌情收费。
5. 擅自拆卸维修者, 不予保修。
6. 以上保修条款仅限于中国市场适用 (不含港澳台地区)。

# 产品服务保证书

姓名: \_\_\_\_\_ 电话: \_\_\_\_\_ 地址: \_\_\_\_\_

商品: \_\_\_\_\_ 型号: \_\_\_\_\_ 购买日期: \_\_\_\_\_ 年 \_\_\_\_ 月 \_\_\_\_ 日

维修记录栏 (由维修员填写)	维修员签名	日期

◆广东得胜电子有限公司 ◆电话: 400-6828-333 ◆地址: 广东省惠州市博罗县龙溪街道富康一路2号

### ■ Preface

Dear Customer,

Thank you for purchasing Takstar PM5 (GEN 2) 48V Phantom Power Supply. In order to better understand and use the product, please read this manual carefully. If you have any questions or suggestions, please contact our local dealer.

### ■ Features

- 48V Phantom Power Supply, compatible with all condenser microphones requiring 48V phantom power supply.
- Built-in low-pass filter circuit effectively eliminates signal interference to ensure pristine audio transmission.
- DC 48V boost rectifier circuit guarantees stable voltage output while suppressing common-mode interference.
- Dual XLR balanced input/output connectors provide stable power delivery with anti-interference capabilities.
- Precision-crafted compact aluminum alloy chassis with anodized finish for wear resistance and portability.
- Built-in 1500mAh lithium battery delivers approximately 10 hours runtime and supports simultaneous charging and operation.

### ■ Applications

Suitable for live streaming karaoke, personal recordings, outdoor performances

### ■ Package Contents

- 1 × PM5 Phantom Power Supply
- 1 × Charging Cable
- 1 × User Manual

### ■ Specifications

- Output Voltage: DC 48V $\pm$ 4V/20mA $\pm$ 20%
- Signal-to-Noise Ratio: 84dB (1kHz@30mVrms)
- Total Harmonic Distortion: THD<0.5% (1kHz)
- Battery Type: Lithium-Ion Battery
- Battery Capacity: 1500mAh
- Charging Specification: 5V=1A
- Charging Time: Approx. 2 hours
- Operating Time: Approx. 10 hours (48V Enabled)
- Net Weight: Approx. 162g
- Dimensions: 100mm  $\times$  38mm  $\times$  44mm (L  $\times$  W  $\times$  H)

Note: The above data are measured by Takstar laboratory which has the final interpretation right!

### ■ Function Descriptions

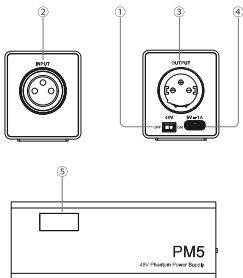

## PM5 (GEN 2) 48V Phantom Power Supply

---

- ① 48V Power Switch: Toggle to the "ON" position to activate 48V power supply; toggle to the "OFF" position to deactivate 48V power supply.
- ② INPUT Port: Standard XLR input connector, used to connect condenser microphones that require 48V phantom power supply.
- ③ OUTPUT Port: Standard XLR output connector, used to connect audio devices such as audio interfaces, mixers, and outdoor speakers.
- ④ Type-C Charging Port: Charge the PM5 Phantom Power Supply via the included charging cable; supports simultaneous charging and operation.
- ⑤ Battery Level Indicator: The battery level icon has 4 segments, with each segment representing 25% of the total battery capacity.

### ■ Operating Instructions

#### I. Usage Instructions

If your audio devices such as audio interfaces, mixers, or speakers do not have a 48V phantom power supply function, making it impossible to connect condenser microphones that require 48V phantom power supply, you can resolve this issue by connecting the "PM5 Phantom Power Supply".

#### II. Connection Method

Below is a description of the connection and usage method for the "PM5 Phantom Power Supply", using Takstar's "OPS-25 PRO Speaker" and "PCM-5600 Handheld Condenser Microphone" as examples:

## PM5 (GEN 2) 48V Phantom Power Supply

---

1. First, connect the "PM5 Phantom Power Supply" to the Takstar "PCM-5600 Microphone". Use the female XLR connector end of Takstar's "C3-2 Male-to-Female XLR Cable" (the cable needs to be purchased separately) to connect to the "PCM-5600 Microphone", and the male XLR connector end to connect to the INPUT port of the "PM5 Phantom Power Supply".
2. Connect the "PM5 Phantom Power Supply" to the "OPS-25 PRO Speaker". Use the XLR connector end of Takstar's "XLR-to- $\Phi$ 6.3mm Microphone Cable" (the cable needs to be purchased separately) to connect to the OUTPUT port of the "PM5 Phantom Power Supply", and the  $\Phi$ 6.3mm plug end to connect to the microphone port of the "OPS-25 PRO Speaker".
3. To avoid equipment damage from current surge, turn on the Phantom Power Supply first, then the audio interface; when shutting down, turn off the audio interface first, then the Phantom Power Supply. Allow an interval of over 5s between on/off operations to ensure the equipment gradually reaches a stable state.
4. The "PM5 Phantom Power Supply" can operate for approximately 9 hours when fully charged. If low battery occurs during use, the "PM5 Phantom Power Supply" also features a simultaneous charging and operation function to eliminate battery life anxiety. You can connect it to a power bank or adapter via the included charging cable to enable simultaneous charging and operation.

## PM5 (GEN 2) 48V Phantom Power Supply

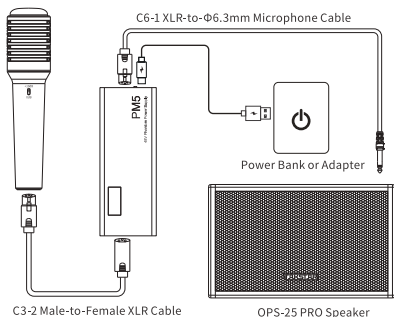

Note: The connection methods for audio interfaces and mixers are similar; details are omitted here.

### III. Charging Instructions

1. Turn on the 48V power supply switch. When the last segment of the power indicator light flashes red, it indicates low battery, and charging is required promptly.
2. Use the included Type-C charging cable to connect to an adapter for charging. During charging, the power indicator lights up green segment by segment, indicating that it is charging. Once fully charged, the power indicator shows all segments. It takes approximately 2 hours to fully charge using a 5V=1A DC power supply. When the battery is fully charged, please stop charging it to prevent battery overcharge.

3. For the first use, it is recommended to fully charge the device first. If not in use for a long time, charge the "PM5 Phantom Power Supply" once every six months to prevent over-discharging and avoid impact on battery performance.

### ■ Safety Instructions

To avoid electric shock, overheat, fire, radiation, explosion, mechanical risk and injury or property loss due to improper use, please read and observe the following items before use:

1. Please check if the power of the connected equipment matches with that of this product before operation. Adjust the volume to proper level during operation. Do not operate at over-power or high-volume level for extended time to avoid product malfunction.
2. If there is any abnormality during use (e.g., smoke, strange odor), please kill the power switch and unplug from power source, then send the product to the local after-sales service for repair.
3. Consumers should purchase a matching power adapter that has obtained CCC certification and meets the required standards when using a power adapter for power supply.
4. Keep this product and its accessories in a dry and ventilated area. Do not store in a humid or dusty area for extended time. Keep away from fire, rain, liquid intrusion, bumping, throwing, vibrating, or from blocking any ventilation openings, to prevent malfunction.

5. The product must, when installed on walls or ceilings, be fixed firmly in place at adequate strength to prevent from falling.
6. Please abide by safety rules during operation. Do not use the product in places prohibited by laws or regulations to avoid accident.
7. Do not disassemble or repair the product unauthorized to avoid injury. If you have any questions or require any services, please contact our local after-sales service.

### ■ Label Meanings



This symbol indicates that this product should not be disposed of with your household waste, according to the WEEE directive (2012/19/EU) and your national law. This product should be handed over to an authorized collection site for recycling waste electrical and electronic equipment (WEEE). Improper handling of this type of waste could have a possible negative impact on the environment and human health due to potentially hazardous substances that are generally associated with WEEE. At the same time, your cooperation in the correct disposal of this product will contribute to the effective usage of natural resources. For more information about where you can drop off your waste equipment for recycling, please contact your local city office, waste authority, or your household waste disposal service.

### ■ About This Manual

This manual contains up-to-date technical specifications as of printing. However, specifications contained herein may not conform to your particular product since Takstar is constantly improving its products. Also, specifications, devices or accessories available may vary from region to region. If you have any questions, please contact our local sales outlet. For the latest version/more information, please visit our website:

<https://www.takstar.com/>

Copyright ©2025 TAKSTAR. TAKSTAR, 得胜 and their respective logos are registered trademarks or trademarks of Takstar company in the PRC, and/or other countries. All other trademarks are the property of their respective owners.



扫一扫, 了解更多产品  
Scan for more  
product information

**广东省电声工程技术研究开发中心  
广东得胜电子有限公司制造**

地址: 广东省惠州市博罗县龙溪街道富康一路2号

服务热线: 400 6828 333 传真: 0752 6383950

邮箱: [xs@takstar.com](mailto:xs@takstar.com)

网址: [www.takstar.com](http://www.takstar.com)

**Designed & Manufactured by:**

Guangdong Takstar Electronic Co., Ltd.

Address: No.2 Fu Kang Yi Rd., Longxi Boluo

Huizhou, Guangdong 516121 China

Tel: 86 752 6383644 Fax: 86 752 6383952

Email: [sales@takstar.com](mailto:sales@takstar.com)

Website: [www.takstar.com](http://www.takstar.com)